



Coastal Waters

Off Market

Expressions of interest

 2  1.5  2





217 | 110 The Wool Road - Worrorring Heights - NSW

 110.68 m² Floor Area

Freshly Painted Two-Bedroom Villa; Your Dream Retirement Awaits!

Nestled in an enviable village location, this charming two-bedroom villa is your gateway to retirement living at its finest. If you desire effortless access to the clubhouse and all its amenities, you've found your perfect match. No more rushing; simply hop or skip across to your activities, events, and social gatherings. Experience the joy of abundant sunshine streaming into your open-plan living space. Thanks to its north-facing orientation, this villa is a light-filled haven. Imagine lounging in the sun-soaked alfresco area, with lush inviting grassy areas— a tranquil retreat right outside your door. Live in a place that keeps you close to the heart of the community. With convenient proximity to the clubhouse, you're at the epicentre of social interactions, fitness activities, and a world of entertainment.

Amenities

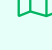
-  Air Conditioning
-  Caravan/Boat storage
-  Ceiling Fans
-  Close to Shops
-  Close to Transport
-  Close to village facilities



1800 550 550
keyton.com.au

*Photographs are for illustrative purposes. Some images may depict items not provided by Keyton within the units such as furniture and other decorative items. **If the contract option chosen by you requires to do so, you will have to pay a departure fee when you leave this village and/or you will have to pay a departure fee when you leave this village, which will impact on the capital gains received when leaving the village, and/or you will have to share any capital gains received with the operator of this village.

217 | 110 The Wool Road - Worring Heights - NSW

🏠 2 📏 1.5 🚗 2

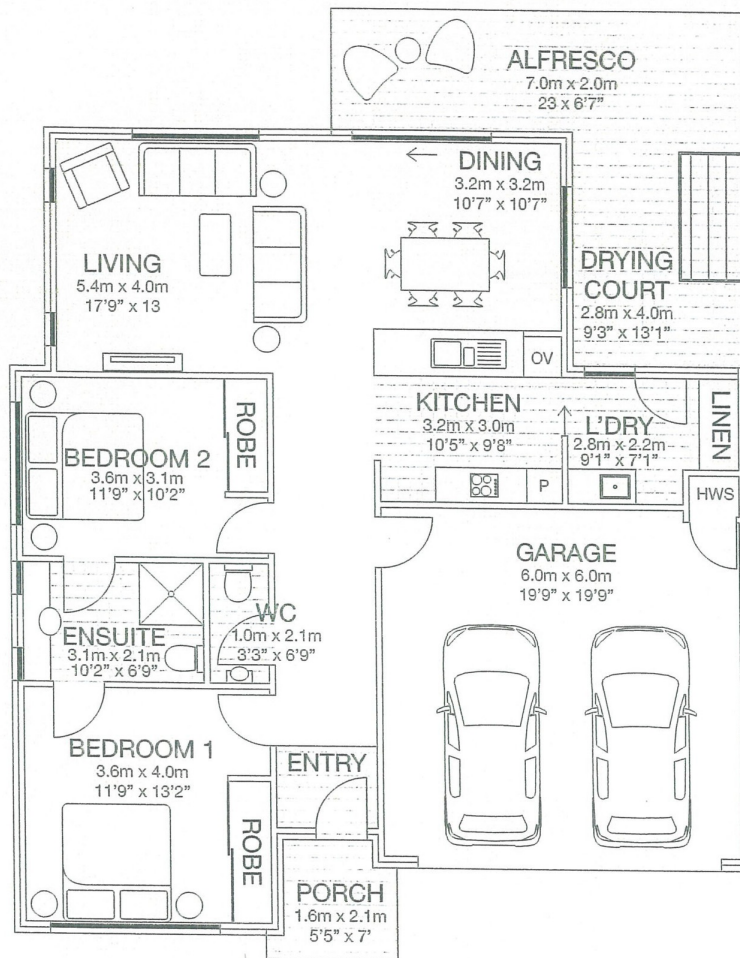

	Metric	Imperial
Living	115m ²	1,237ft ²
Garage	36m ²	387ft ²
Total Area:	151m²	1,624ft²
Alfresco	25.3m ²	272ft ²
Porch	3.5m ²	38ft ²

This is an indicative floor plan that may vary according to home location within the village/resort. The information, dimensions and specifications on this floor plan are believed to be correct but is not guaranteed and may change without notice. Any illustrations are an artist's impression only and subject to change. Keyton gives no warranty concerning the accuracy of the material or information displayed in this brochure and all such warranties (whether implied or otherwise) are excluded to the extent permitted by law. Prospective purchasers should make their own enquiries.