



Abervale

Off Market

\$650,000 - \$700,000







3 2 1

Deakin Floorplan | 50 Abervale Way - GROVEDALE - VIC

138 m² Floor Area

Stunning Home with Spacious Living and Private Backyard Oasis

Amenities

-  Alarm System
-  Built In Wardrobes
-  Close to Parklands
-  Close to Shops
-  Dishwasher
-  Flooring - vinyl planks



1800 550 550
keyton.com.au

*Photographs are for illustrative purposes. Some images may depict items not provided by Keyton within the units such as furniture and other decorative items.

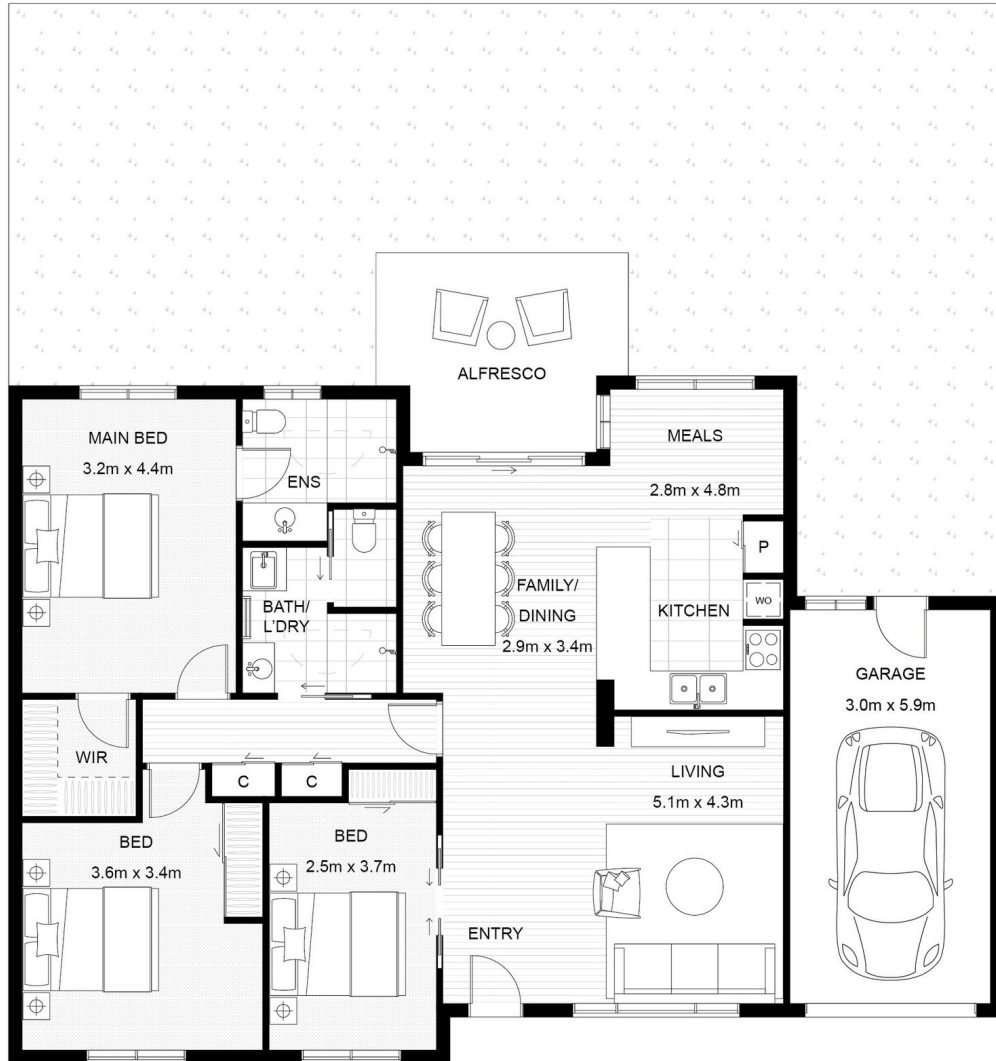

Internal Living	128 m ²
Alfresco	10 m ²
Total Area	138 m²

This is an indicative floor plan that may vary according to home location within the village/resort. The information, dimensions and specifications on this floor plan are believed to be correct but is not guaranteed and may change without notice. Any illustrations are an artist's impression only and subject to change. Keyton gives no warranty concerning the accuracy of the material or information displayed in this brochure and all such warranties (whether implied or otherwise) are excluded to the extent permitted by law. Prospective purchasers should make their own enquiries.