



Annesley Bowral

For Sale

\$1,200,000

🛏️ 2 🍽️ 2 🚗 1

15/10 Westwood Drive - Bowral - NSW

North-Facing Garden Apartment in the Heart of Annesley

Beautifully presented and rich in Southern Highlands charm, this elegant two-bedroom villa offers refined living within the prestigious Annesley Village Bowral community. High ceilings enhance the sense of space and natural light, while two well-appointed bathrooms and a secure single garage provide everyday comfort and convenience. With its welcoming atmosphere, thoughtful layout and timeless appeal, this home is perfectly suited to those seeking relaxed, low-maintenance living in a peaceful village setting.

Amenities

- 🏠 Built-ins
- 🌿 Courtyard
- 🍽️ Dishwasher



1800 550 550
keyton.com.au

*Photographs are for illustrative purposes. Some images may depict items not provided by Keyton within the units such as furniture and other decorative items. **If the contract option chosen by you requires to do so, you will have to pay a departure fee when you leave this village and/or you will have to pay a departure fee when you leave this village, which will impact on the capital gains received when leaving the village, and/or you will have to share any capital gains received with the operator of this village.



15/10 Westwood Drive - Bowral - NSW

🏠 2 🛏 2 🚿 1

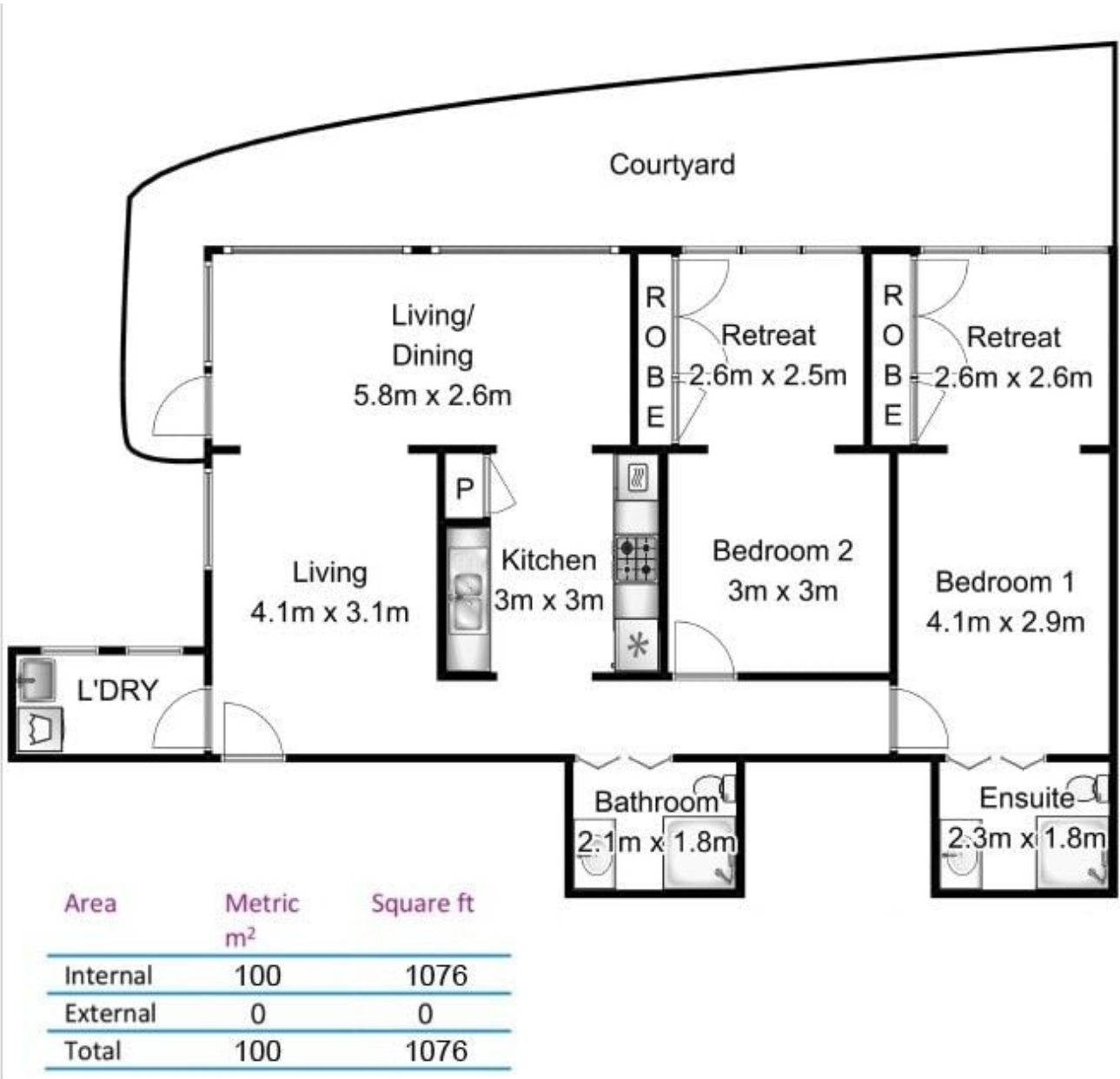

This is an indicative floor plan that may vary according to home location within the village/resort. The information, dimensions and specifications on this floor plan are believed to be correct but is not guaranteed and may change without notice. Any illustrations are an artist's impression only and subject to change. Keyton gives no warranty concerning the accuracy of the material or information displayed in this brochure and all such warranties (whether implied or otherwise) are excluded to the extent permitted by law. Prospective purchasers should make their own enquiries.