



Pittwater Village

For Sale

\$1,150,000

🛏 2 🚿 2

003/16-32 Mona Vale Road - Mona Vale - NSW

Mona Vale on Your Doorstep

Wake up in the heart of Mona Vale, where cafés, shopping, restaurants and beautiful beaches are all within easy reach. This elevated north-facing home features two spacious bedrooms, a separate study, light-filled open-plan living and a modern kitchen with stone benchtops and dishwasher. Complete with reverse-cycle air conditioning, generous storage, a walk-in shower and main bedroom with ensuite, it's a home designed to make the most of the lifestyle right outside your door.

Amenities

- 🌬 Air Conditioning
- 🏠 Balcony
- 🌀 Ceiling Fans
- 🍽 Dishwasher
- 🍳 Modern Kitchen
- 📖 Study



1800 550 550
keyton.com.au

*Photographs are for illustrative purposes. Some images may depict items not provided by Keyton within the units such as furniture and other decorative items. **If the contract option chosen by you requires to do so, you will have to pay a departure fee when you leave this village and/or you will have to pay a departure fee when you leave this village, which will impact on the capital gains received when leaving the village, and/or you will have to share any capital gains received with the operator of this village.

003/16-32 Mona Vale Road - Mona Vale - NSW

 2  2

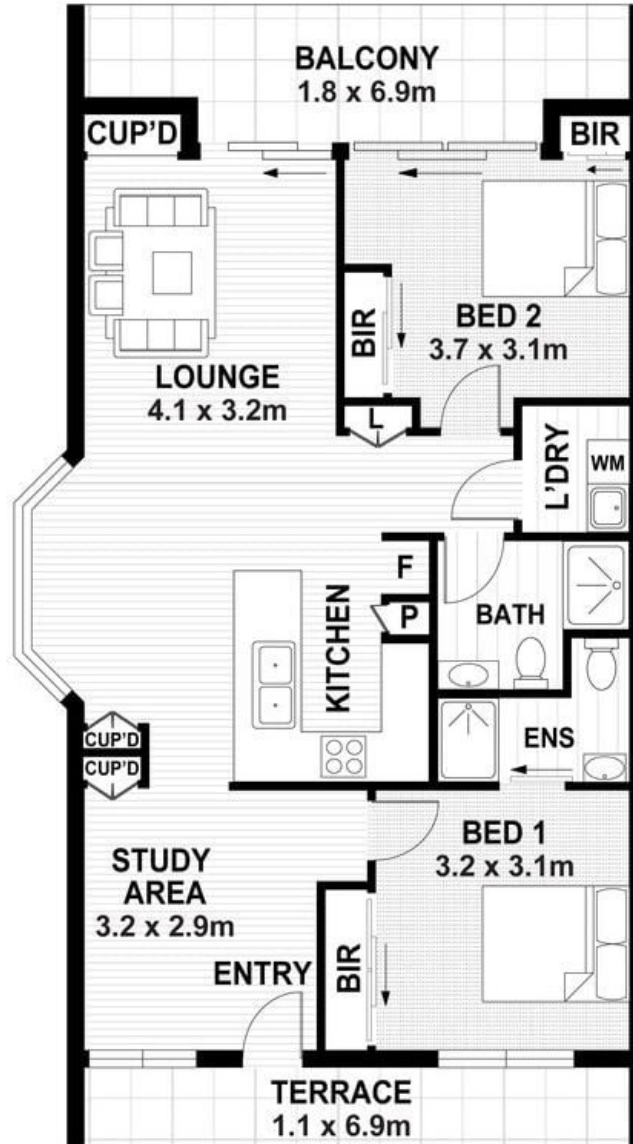

Internal Living	80 m ²
External	20 m ²
Total Area	100 m²



This is an indicative floor plan that may vary according to home location within the village/resort. The information, dimensions and specifications on this floor plan are believed to be correct but is not guaranteed and may change without notice. Any illustrations are an artist's impression only and subject to change. Keyton gives no warranty concerning the accuracy of the material or information displayed in this brochure and all such warranties (whether implied or otherwise) are excluded to the extent permitted by law. Prospective purchasers should make their own enquiries.